

JOHNSON POINT

HENDERSON INLET

BAIRD COVE

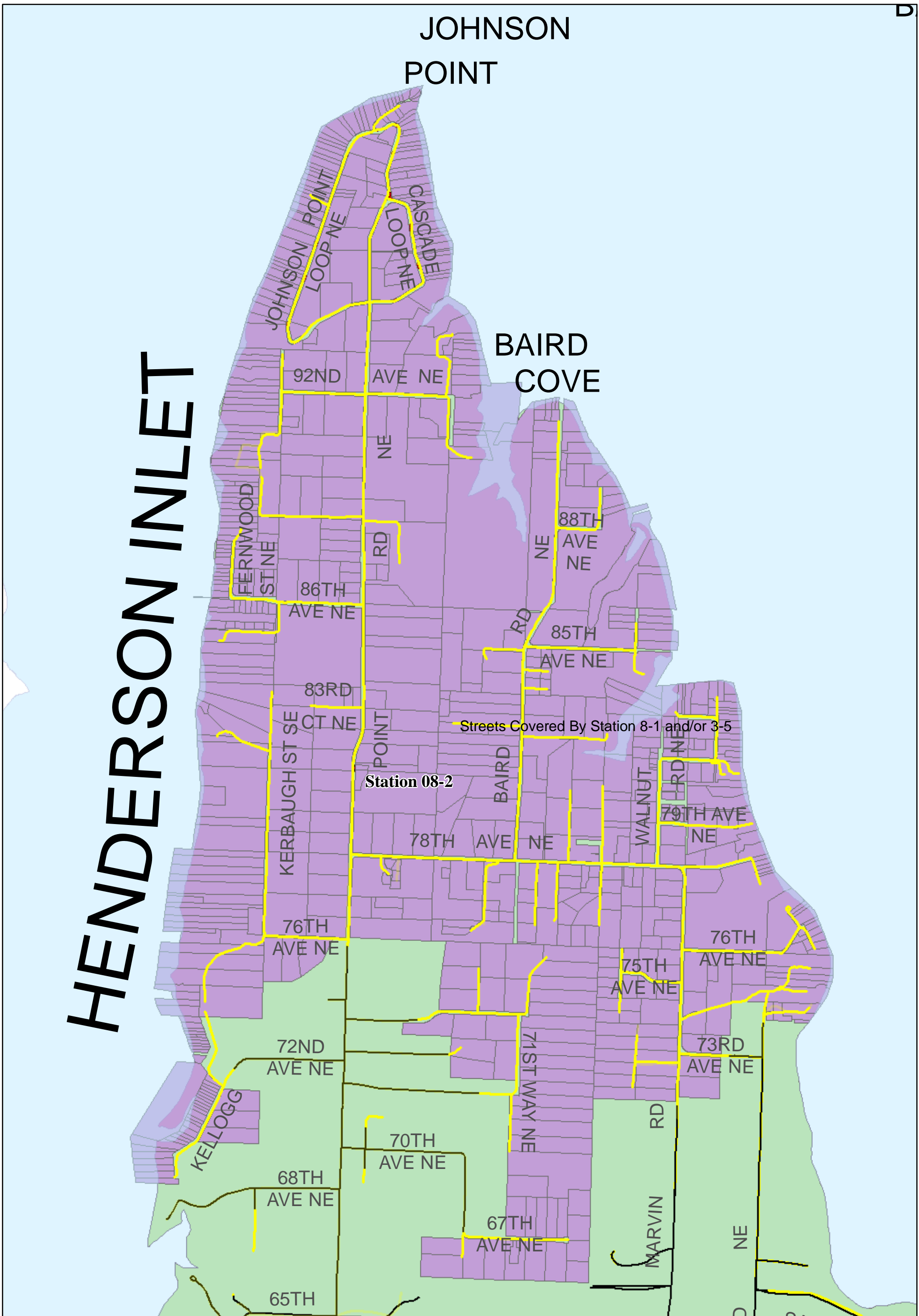





Streets Covered By Station 8-1 and/or 3-5

Station 08-2

South Bay Fire District #8

Johnson Point Parcels Not Covered By Station 8-1 and 3-5

-  Parcels Not Covered By Station 8-1 and/or 3-5
-  Streets Covered By Station 8-1 and/or 3-5
-  Streets Outside Service Area
-  Waterbodies
-  South Bay Fire District #8

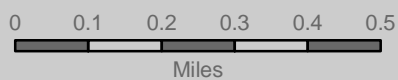

Thurston County makes every effort to ensure that this map is a true and accurate representation of the work of County government. However, the County and all related personnel make no warranty, expressed or implied, regarding the accuracy, completeness or convenience of any information disclosed on this map. Nor does the County accept liability for any damage or injury caused by the use of this map.

To the fullest extent permissible pursuant to applicable law, Thurston County disclaims all warranties, express or implied, including, but not limited to, implied warranties of merchantability, data fitness for a particular purpose, and non-infringement of proprietary rights.

Under no circumstances, including, but not limited to, negligence, shall Thurston County be liable for any direct, indirect, incidental, special or consequential damages that result from the use of, or the inability to use, Thurston County materials.

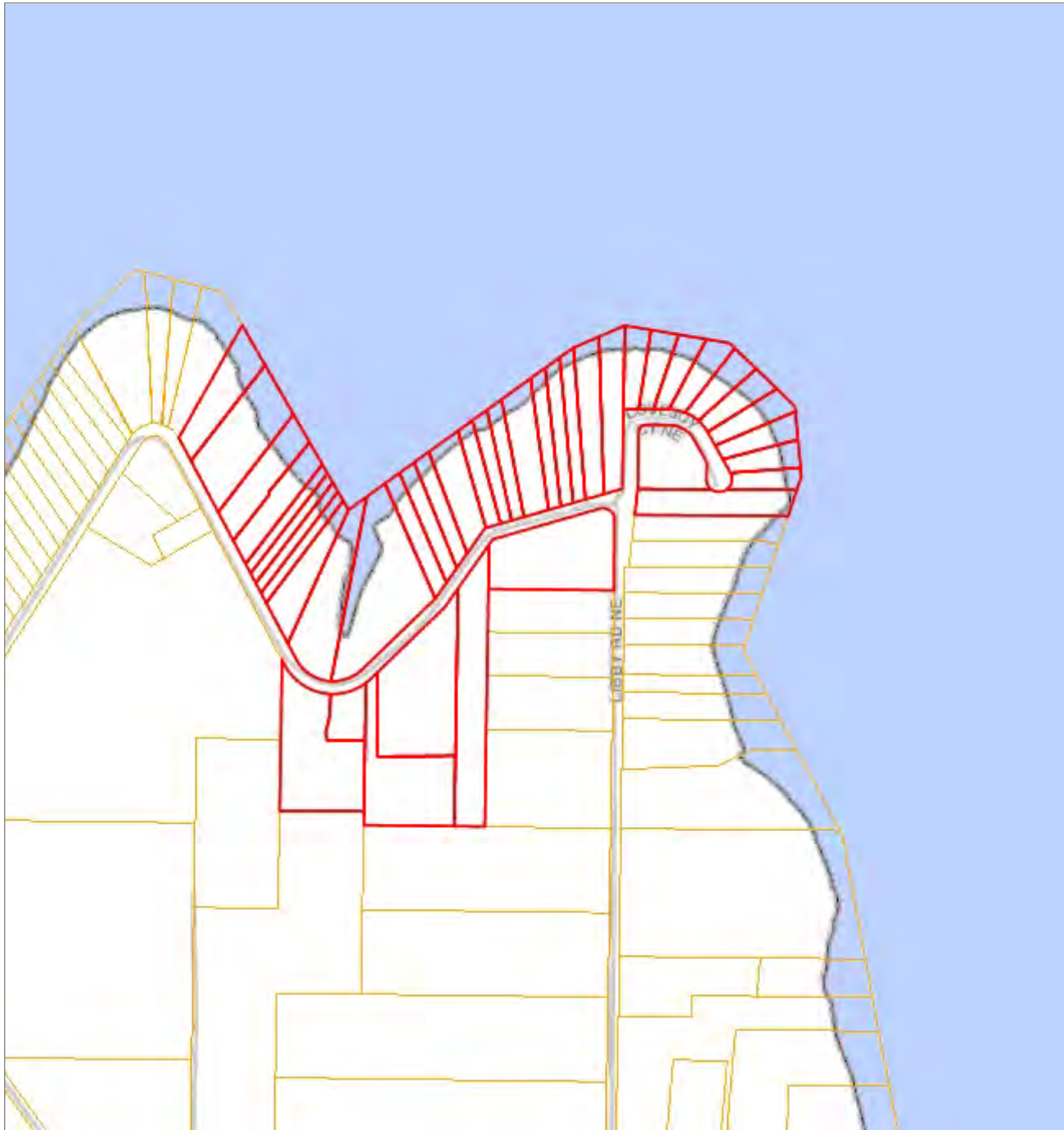

FISHTRAP LOOP: **Map of Parcels Not Within 5 Road Miles of a Firestation**

Scale 1: 7,413

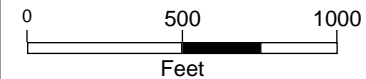

Author: ECD- 08/20/2015

Published: 8/20/2015

Note: Chief VanCamp,
Here are the parcels that you
gave me. I calculated the total
value using the Assessor's data.

The estimated total value of the
parcels shown is:
\$18,104,900.00



Thurston County and all related personnel make no warranty, expressed or implied, regarding the accuracy, completeness or convenience of any information disclosed on this map. Nor does the County accept liability for any damage or injury caused by the use of this map. To the fullest extent permissible pursuant to applicable law, Thurston County disclaims all warranties, express or implied, including, but not limited to, implied warranties of merchant ability, data fitness for a particular purpose, and non-infringements of proprietary rights. Under no circumstances, including, but not limited to, negligence, shall Thurston County be liable for any direct, indirect, incidental, special or consequential damages that result from the use of, or the inability to use, Thurston County materials.

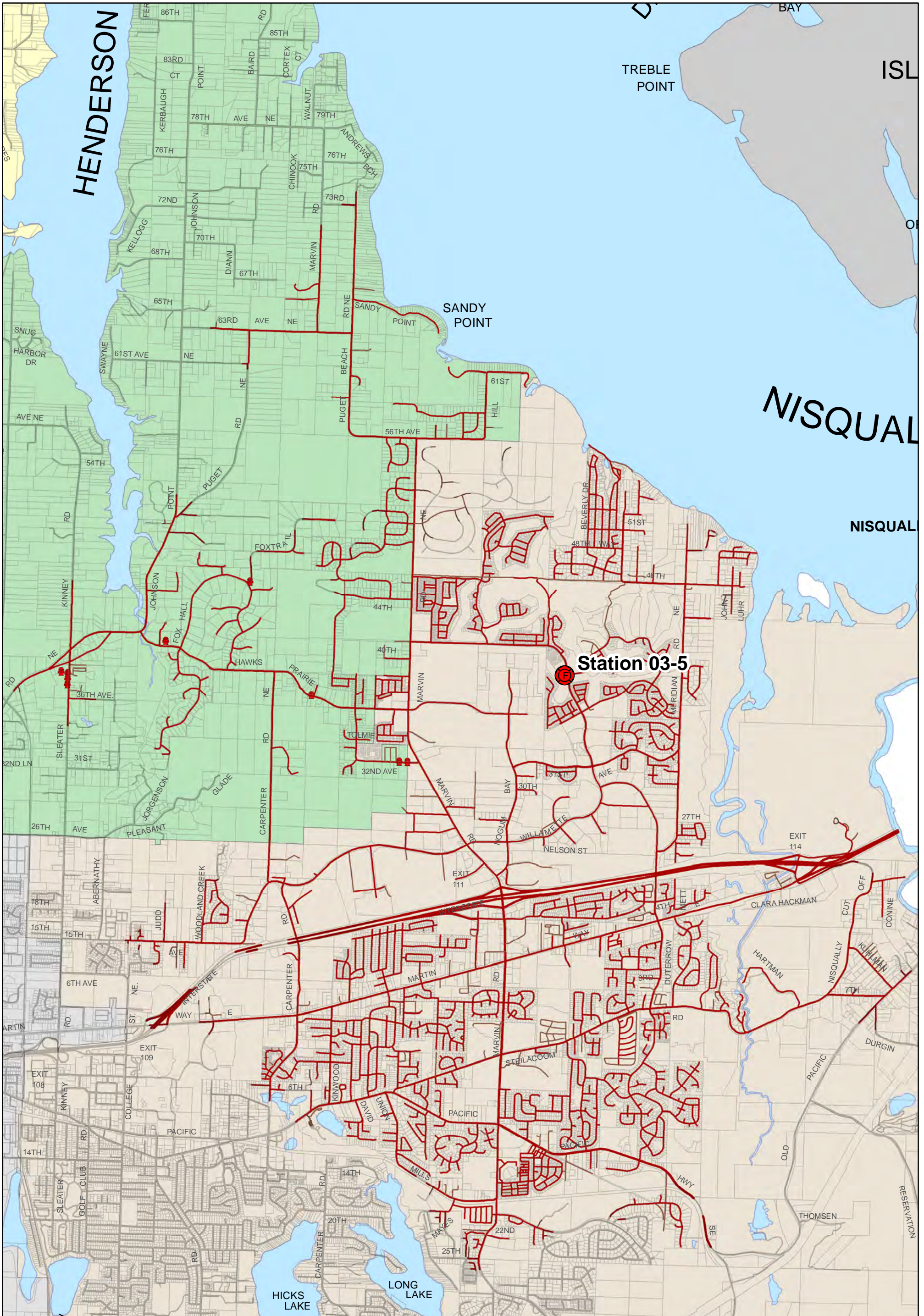

- | | |
|-------------------------------|--------------------------------|
| In 5 Mile Service Area | Outside Service Area |
| Major Roads | Major Roads |
| Minor Roads | Minor Roads |
| Highways | Highways |
| Other Roads | Other Roads |
| FireStation_35 | Lacey |
| Fire Hydrants | North Olympia Fire District #7 |
| Parcels | South Bay Fire District #8 |
| Waterbodies | Other Fire Districts |
| | Islands |



Lacey Fire District #3
Station 3-5
5 Mile Drive-Time Response Map

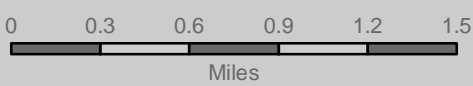

Thurston County makes every effort to ensure that this map is a true and accurate representation of the work of County government. However, the County and all related personnel make no warranty, expressed or implied, regarding the accuracy, completeness or convenience of any information disclosed on this map. Nor does the County accept liability for any damage or injury caused by the use of this map.

To the fullest extent permissible pursuant to applicable law, Thurston County disclaims all warranties, express or implied, including, but not limited to, implied warranties of merchantability, data fitness for a particular purpose, and non-infringements of proprietary rights.

Under no circumstances, including, but not limited to, negligence, shall Thurston County be liable for any direct, indirect, incidental, special or consequential damages that result from the use of, or the inability to use, Thurston County materials.

Created By: ECD 3/12/14